

PST ZP772

RECTIFIER DIODE

Features

- Blocking Capability up to 4600 V
- High Surge Rating
- Rugged Ceramic Hermetic Package

ELECTRICAL CHARACTERISTICS AND RATINGS

Blocking

| Parameter | Symbol | Min | Max | Typ | Unit | Conditions |
|-------------------------------------|-----------|-----|------|-----|------|--|
| Repetitive peak reverse voltage | V_{RRM} | | 4600 | | V | $T_j = -40\text{ }^{\circ}\text{C}$ to $175\text{ }^{\circ}\text{C}$ |
| Non repetitive peak reverse voltage | V_{RSM} | | 4600 | | V | $T_j = -40\text{ }^{\circ}\text{C}$ to $175\text{ }^{\circ}\text{C}$ |
| Repetitive peak reverse current | I_{RRM} | | 200 | | mA | $T_j = T_{jmax}$, $V = V_{RRM}$ |

Conducting

| Parameter | Symbol | Min | Max | Typ | Unit | Conditions |
|---|--------------|-----|-------|-----|-----------------------|--|
| Average value of forward current | $I_{F(AV)}$ | | 4020 | | A | 50 Hz sinewave, 180° conduction, $T_c = 85\text{ }^{\circ}\text{C}$ |
| RMS value of forward current | $I_{F(RMS)}$ | | 6300 | | A | 50 Hz sinewave, 180° conduction, $T_c = 85\text{ }^{\circ}\text{C}$ |
| Peak one cycle surge (non repetitive) current | I_{FSM} | | 45 | | kA | 50 Hz sinewave, 180° conduction, $T_j = T_{jmax}$, $V_R = 0$ |
| I square t | $I^2 t$ | | 10125 | | kA^2s | $T_j = T_{jmax}$ |
| Peak forward voltage | V_{FM} | | 1.3 | | V | Forward current 3000 A, $T_j = T_{jmax}$ |
| Threshold voltage | $V_{F(TO)}$ | | 0.75 | | V | $T_j = T_{jmax}$ |
| Forward slope resistance | r_F | | 0.175 | | $\text{m}\Omega$ | $T_j = T_{jmax}$ |

Thermal and mechanical characteristics and ratings

| Parameter | Symbol | Min | Max | Typ | Unit | Conditions |
|-------------------------------------|---------------|-----|-------|------|-----------------------------|--|
| Operating temperature | T_j | -40 | 175 | | $^{\circ}\text{C}$ | |
| Storage temperature | T_{stg} | -40 | 175 | | $^{\circ}\text{C}$ | |
| Thermal resistance junction to case | $R_{th(j-c)}$ | | 0.009 | | $^{\circ}\text{C}/\text{W}$ | Double side cooled, 180° SIN |
| Thermal resistance case to sink | $R_{th(c-s)}$ | | 0.002 | | $^{\circ}\text{C}/\text{W}$ | Mounting surfaces smooth, flat and greased |
| Mounting force | F | 46 | 54 | | kN | |
| Weight | W | | | 1700 | g | |

PST ZP772

RECTIFIER DIODE

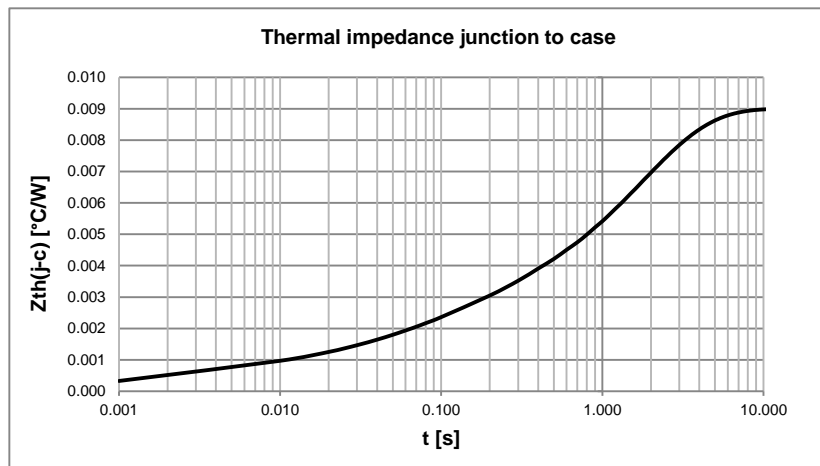
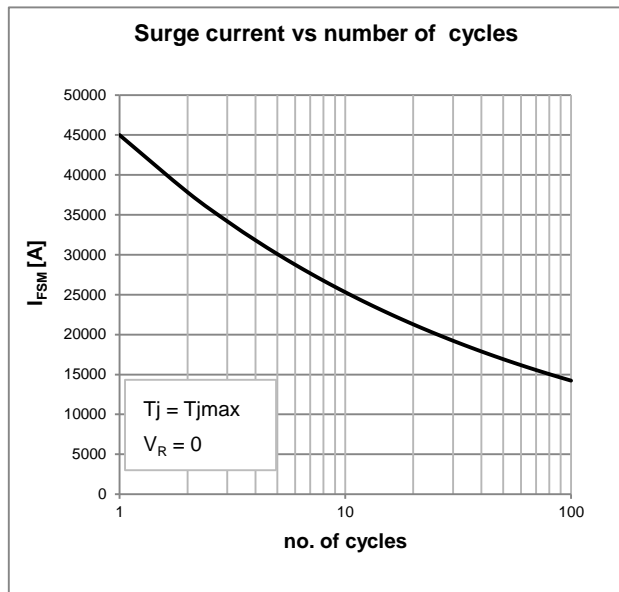
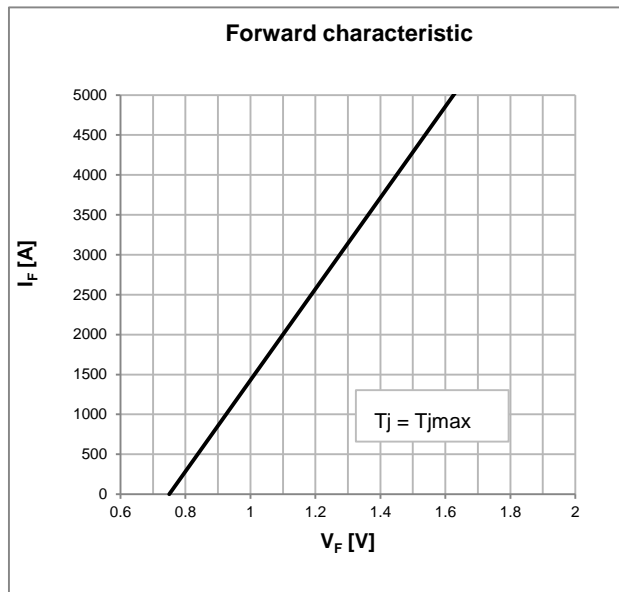

OUTLINE AND DIMENSIONS

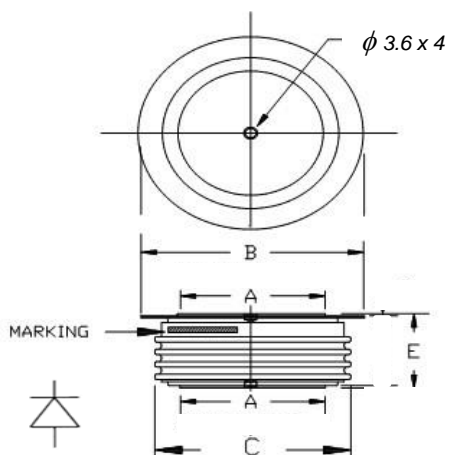

| | A | B | C | E |
|----|----|-----|-----|--------|
| mm | 85 | 118 | 109 | 35 ± 2 |

- All the characteristics given in this data sheet are guaranteed only with uniform clamping force, cleaned and lubricated heatsink surfaces with flatness < 0.03 mm and roughness < 2 μ m